



UNIT 1B 120 CAMBRIDGE ROAD
 ROSNY PARK 7018
 PHONE: (03)6244 6256
 FAX: (03)6244 6221
 MOBILE: 0418 120 796
 EMAIL: admin@rbsurveyors.com

This plan has been prepared only for the purpose of obtaining preliminary subdivisional approval from the local authority and is subject to that approval

All measurements and areas are subject to the final survey

PROPOSED SUBDIVISION

OWNER CLAREMONT GOLF CLUB INC.

LOCATION 109 CADBURY ROAD
 CLAREMONT

TITLE REFERENCE C.T.65330/1

SCALE 1:1500

DATE 9-10-2013

PROPOSED EASEMENTS AS REQUIRED

GRANTEE SEE TITLE

MUNICIPALITY GLENORCHY

CGC01
 REF. NO. 811901

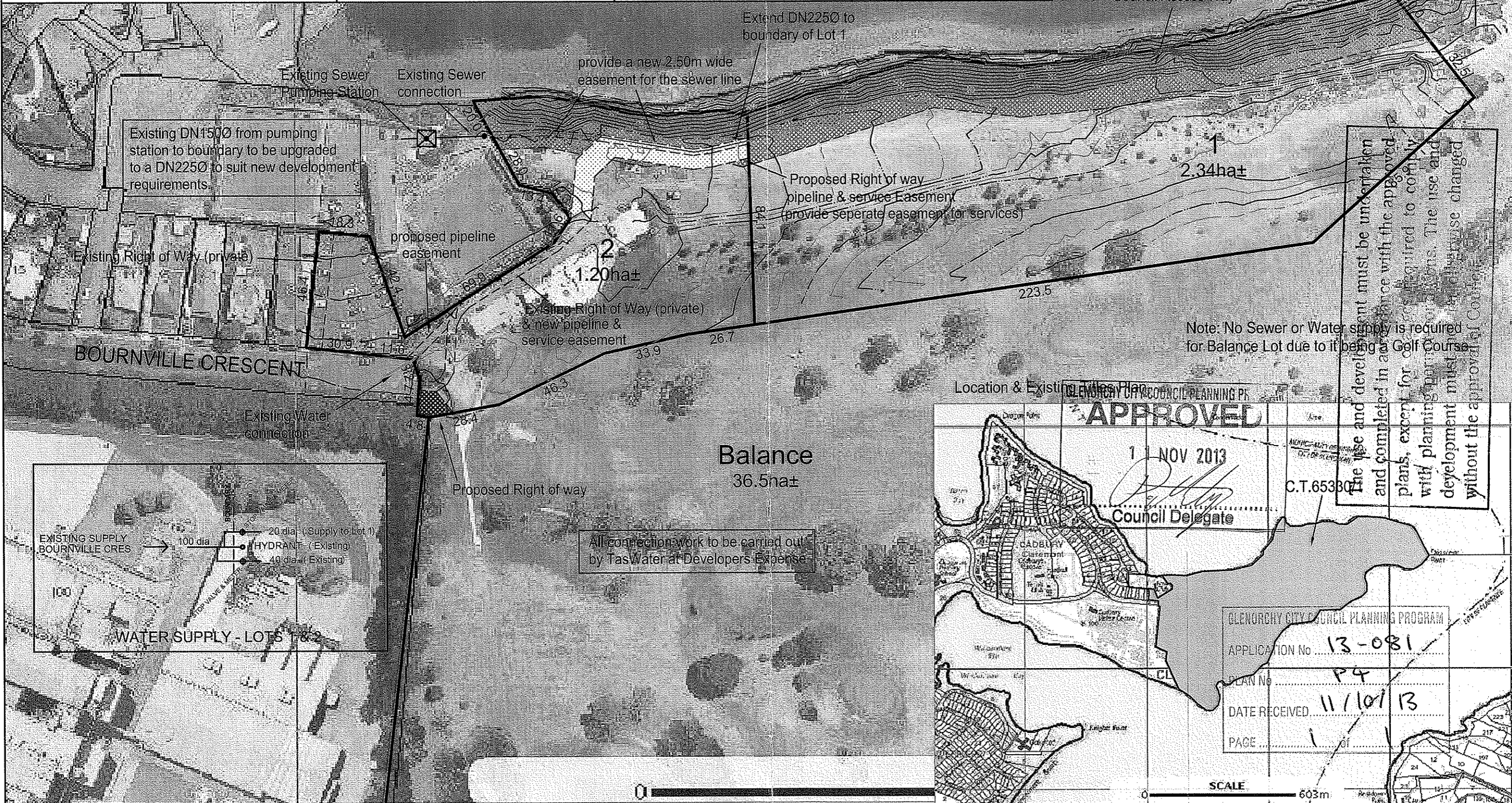

The use and development must be undertaken and completed in accordance with the approved plans, except for those required to comply with planning requirements. The use and development must not otherwise be changed without the approval of Council.

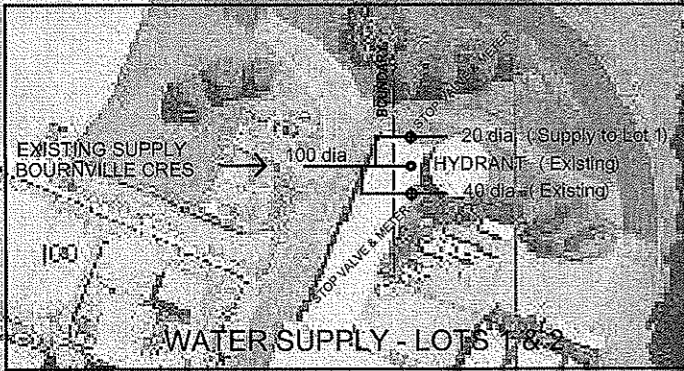

All connection work to be carried out by TasWater at Developers Expense

Location & Existing Zoning Plan

GLENNORCHY CITY COUNCIL PLANNING PROGRAM

APPROVED

1 NOV 2013

Council Delegate

C.T.65330/1

GLENNORCHY CITY COUNCIL PLANNING PROGRAM

APPLICATION No 13-081

PLAN No P4

DATE RECEIVED 11/10/13

PAGE 1 of 1

SCALE 603m