

DEVELOPMENT APPLICATION

APPLICATION NUMBER:	PLN-24-120
PROPOSED DEVELOPMENT:	Partial change of use for Restaurant (Food Services) and alterations to Shop (General Retail and Hire)
LOCATION:	1/30 Derwent Park Road Derwent Park
APPLICANT:	KLM Grocers
ADVERTISING START DATE:	06/05/2025
ADVERTISING EXPIRY DATE:	20/05/2025

Plans and documentation are available for inspection at Council's Offices, located at 374 Main Road, Glenorchy between 8.30 am and 5.00 pm, Monday to Friday (excluding public holidays) and the plans are available on Glenorchy City Council's website (www.gcc.tas.gov.au) until **20/05/2025**.

During this time, any person may make representations relating to the applications by letter addressed to the Chief Executive Officer, Glenorchy City Council, PO Box 103, Glenorchy 7010 or by email to gccmail@gcc.tas.gov.au.

Representations must be received by no later than 11.59 pm on **20/05/2025**, or for postal and hand delivered representations, by 5.00 pm on **20/05/2025**.

PROJECT TITLE : - PROPOSED RENOVATION & IMPROVEMENT OF EXISTING RETAIL STORE
AT 1/30 DERWENT PARK, DERWENT PARK ROAD, HOBART. TAS-7009

GLENORCHY CITY COUNCIL
PLANNING SERVICES
APPLICATION No PLN-24-120
DATE RECEIVED 24 April 2025

Date : 21-05-2024

Client:

Mr. LOVLEEN GUPTA

KLM FOODS PTY LTD

Site Address:

30-DERWENT PARK,
DERWENT PARK ROAD,
HOBART.

GENERAL NOTES:

CHECK ALL DIMENSIONS AND
MEASUREMENTS ON SITE PRIOR TO
FABRICATION AND OR CONSTRUCTION.
DIMENSIONS ARE IN MILLIMETERS
"FRAME TO FRAME" AND DO NOT
ALLOW FOR INTERIOR LININGS.

DO NOT SCALE DRAWINGS.
IF IN DOUBT ASK.

ALL WORK IN ACCORDANCE WITH
THE BUILDING CODE OF AUSTRALIA
(BCA) AS AMENDED, RELEVANT
AUSTRALIAN STANDARDS (AS) CODES
AND GOOD BUILDING PRACTICES.
DRAWINGS TO BE READ IN
CONJUNCTION WITH SPECIFICATIONS
AND SCHEDULES.

ISSUE	DESCRIPTION	DATE
R1	AREA MATRIX AND NOTES ADVISED BY TASWATER ADDED	22-04-2025

File Number:
KLM/HCC/ARCH/21/05/2024

Title:
LAYOUT PLAN

Sheet Original:
A - 3

Scale:
1:200

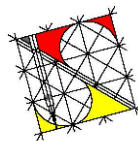

urban space designers
Building Design And Drafting

TASMANIA . VICTORIA

HEMANT KHANNA
0402438170
hemant_khanna@yahoo.com
info@urbanspacedesigners.com.au

Drawn By:
G K

Drawing Number:

BA-01

NOTE: DEVELOPER IS RESPONSIBLE FOR ARRANGING TO LOCATE THE EXISTING TASWATER
INFRASTRUCTURE AND CLEARLY SHOWING IT ON THE DRAWINGS. EXISTING TASWATER
INFRASTRUCTURE MAY BE LOCATED BY THE SURVEYOR AND/OR A PRIVATE CONTRACTOR
ENGAGED AT THE DEVELOPER'S COST TO LOCATE THE INFRASTRUCTURE.

AREA MATRIX

EXISTING USE: -

RETAIL AREA 427.00 SQM

PROPOSED USE: -

RETAIL AREA 382.50 SQM

DINING AREA 25.00 SQM

KITCHEN AREA 19.50 SQM



EXISTING RAMP

NOTE: THE ENGINEERING DESIGN CALCULATIONS MUST COMPLY WITH AS/NZS 3500
PLUMBING AND DRAINAGE AND THE SEWERAGE AND WATER CODES OF AUSTRALIA -
MELBOURNE RETAIL WATER AGENCIES INTEGRATED CODE VERSIONS PUBLISHED
BY THE WATER SERVICES ASSOCIATION OF AUSTRALIA AND AS AMENDED BY
TASWATER'S SUPPLEMENTS.

TABLE 4.3

SPECIFIC REQUIREMENTS FOR FIXTURES, FITTINGS AND EQUIPMENT

Type of fixture, fitting or equipment	Requirements
Refrigerated counters—whether a number of refrigerated cabinets or a frame in one piece	A continuous top of stainless steel cast or welded in one piece, free of open or rough joints, cracks and crevices and rough surfaces Raised edge or lip formed around each opening in the bar top sufficient to prevent material falling into the food wells
Counters and bars, food display units, window display and self-service display cabinets and bain-maries	All surfaces shall be smooth, durable, impervious and free from cracks, crevices and cavities The underside shall have an impervious finish Window displays for wet foods, e.g., meat, fish shall be covered at all intersections and installed in accordance with AS/NZS 3500.2.2
Cupboards and cabinets	The rear face of plywood, hardboard and similar materials used for backing shall be finished with a smooth, washable surface No backing shall be provided where the cupboard abuts a wall but the wall shall be finished with a smooth washable surface
Doors for cupboards and cabinets	Sliding doors shall be hung from the top of the door (if fitted) Bottom guides or runners shall terminate not less than 25 mm from each end of the door opening
Counters for food preparation in front of the customer	Protective barrier to provide a physical barrier between the customer and the food
Dumb waiters (food conveyors)	The compartment holding the food must be made of smooth impervious surfaces, free from crevices and open joints The walls of the shaft of vertical conveyors must be made of smooth material, free of crevices and cracks Access must be provided for cleaning

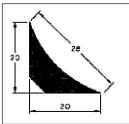
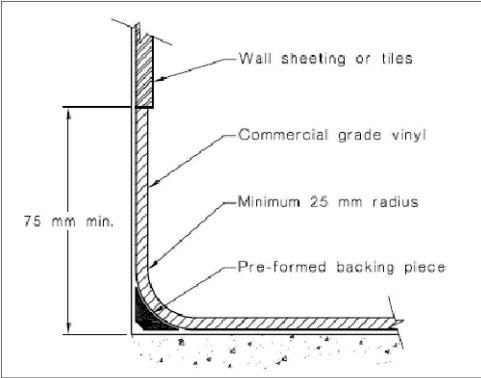

AREA UNDER
PROPOSAL

LAYOUT PLAN

NOTE: -

- The information contained in this document is copyright and may not be used or reproduced for any other project or purpose. Verify all dimensions and levels on site and report any discrepancies to URBAN SPACE DESIGNERS for direction prior to the commencement of work. Drawings to be read in conjunction with all other contract documents. Use figured dimensions only. Do not scale from drawings. URBAN SPACE DESIGNERS cannot guarantee the accuracy of content and format for copies of drawings issued electronically. If in doubt ask. The completion of the issued details checked and authorized section below is confirmation of the status of the drawing. The drawing shall not be used for the construction unless endorsed "for construction" and authorized for issue.
- Read these drawings in conjunctions with drawings prepared by Urban space designers. Refer any discrepancies with the designer before proceeding with any building works.

DEVELOPMENT APPLICATION

PROJECT TEAM:

Document Set ID: 3481897

Version: 1, This drawing has been prepared by & IS THE PROPERTY OF URBAN SPACE DESIGNERS - LICENCED BUILDING DESIGNERS AND MAY ONLY BE USED FOR THE PURPOSE FOR WHICH IT WAS COMMISSIONED.

copyright

PROJECT TITLE : - PROPOSED RENOVATION & IMPROVEMENT OF EXISTING RETAIL STORE
AT 1/30 DERWENT PARK, DERWENT PARK ROAD, HOBART. TAS-7009

GLENORCHY CITY COUNCIL
PLANNING SERVICES
APPLICATION No PLN-24-120
DATE RECEIVED 24 April 2025

Date : 21-05-2024

Client:

Mr. LOVLEEN GUPTA

KLM FOODS PTY LTD

Site Address:

1/30-DERWENT PARK,
DERWENT PARK ROAD,
HOBART.

GENERAL NOTES:

CHECK ALL DIMENSIONS AND
MEASUREMENTS ON SITE PRIOR TO
FABRICATION AND OR CONSTRUCTION.
DIMENSIONS ARE IN MILLIMETERS
"FRAME TO FRAME" AND DO NOT
ALLOW FOR INTERIOR LININGS.

DO NOT SCALE DRAWINGS.
IF IN DOUBT ASK.

ALL WORK IN ACCORDANCE WITH
THE BUILDING CODE OF AUSTRALIA
(BCA) AS AMENDED, RELEVANT
AUSTRALIAN STANDARDS (AS) CODES
AND GOOD BUILDING PRACTICES.
DRAWINGS TO BE READ IN
CONJUNCTION WITH SPECIFICATIONS
AND SCHEDULES.

ISSUE	DESCRIPTION	DATE
R1	AREA MATRIX AND NOTES ADVISED BY TASWATER ADDED	22-04-2025

File Number:
KLM/HCC/ARCH/21/05/2024

Title:
KITCHEN
LAYOUT PLAN
& EQUIPMENT LIST

Sheet Original:
A - 3

Scale:
1:50

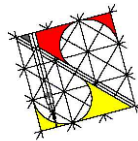

urban space designers
Building Design And Drafting

TASMANIA . VICTORIA

HEMANT KHANNA
0402438170
hemant_khanna@yahoo.com
info@urbanspacedesigners.com.au

Drawn By:
G K

Drawing Number:

BA-02

KITCHEN LAYOUT PLAN
&
EQUIPMENTS LEGEND

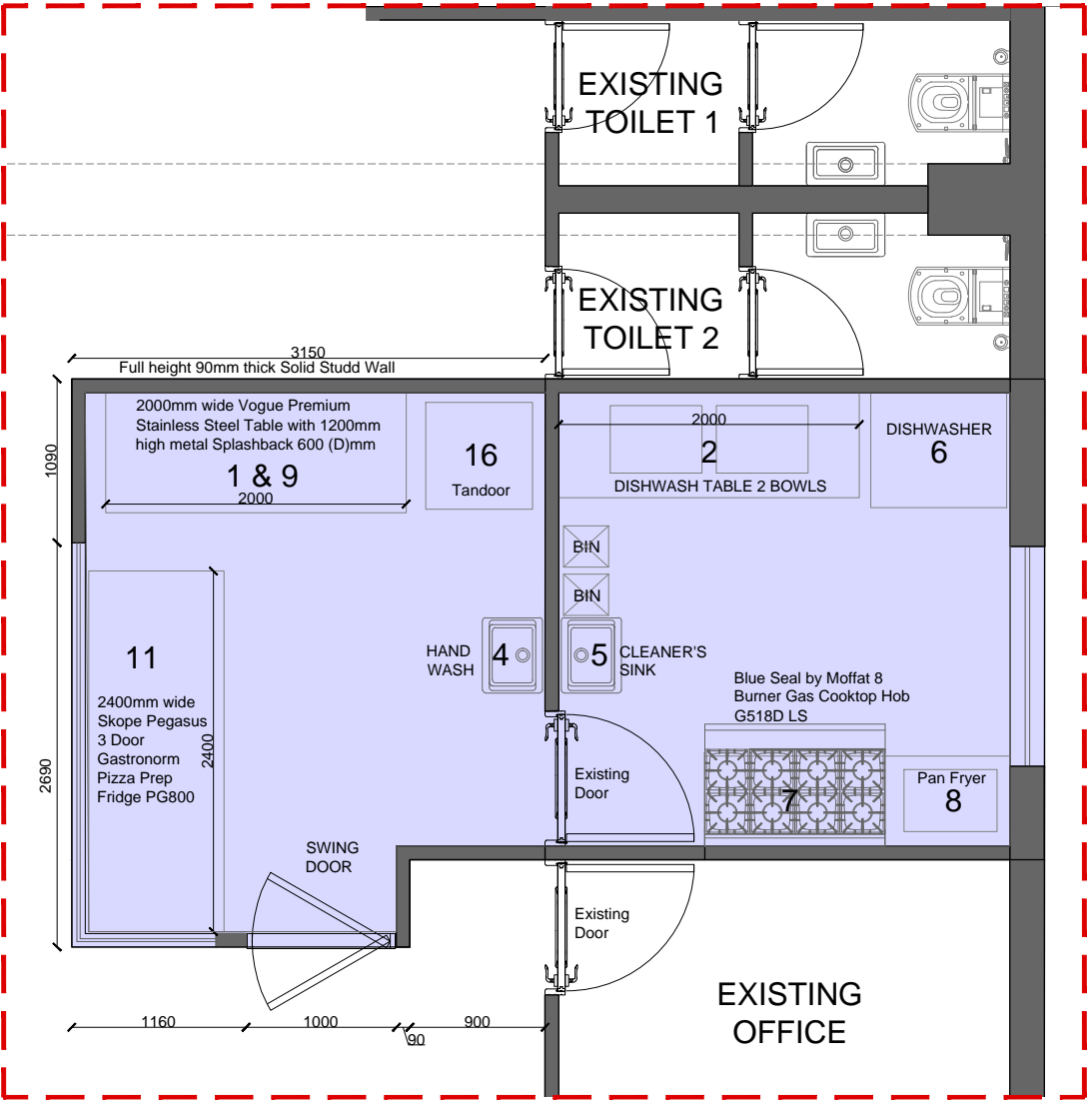

1. Vogue Premium Stainless Steel Table with Splashback 600(D)mm



2. Vogue Dishwasher Inlet Table with Double Bowl Sink 90mm outlet 2400x700x960mmL/H



4. 3monkeez Wall-Mounted Hand Basin and Brackets



5. Stoddart Plumbing Cleaners Sink with Splashback



6. Washtech by Moffat High Efficiency Passthrough Ware washer With Heat Condenser AL8C



7. Blue Seal by Moffat 8 Burner Gas Cooktop Hob G518D LS



9. Roband Griddle



11. Skope Pegasus 3 Door Gastronorm Pizza Prep Fridge PG800



16. GT-710AG Natural Gas or LPG 15.9 (NG)/ 25.6 (LPG) Tandoor



8. Roband Double Pan Fryer 2 x 8Ltr F28



NOTE: -

- 1) The information contained in this document is copyright and may not be used or reproduced for any other project or purpose. Verify all dimensions and levels on site and report any discrepancies to URBAN SPACE DESIGNERS for direction prior to the commencement of work. Drawings to be read in conjunction with all other contract documents. Use figured dimensions only. Do not scale from drawings. URBAN SPACE DESIGNERS cannot guarantee the accuracy of content and format for copies of drawings issued electronically. If in doubt ask. The completion of the issued details checked and authorized section below is confirmation of the status of the drawing. The drawing shall not be used for the construction unless endorsed "for construction" and authorized for issue.
- 2) Read these drawings in conjunctions with drawings prepared by Urban space designers. Refer any discrepancies with the designer before proceeding with any building works.

DEVELOPMENT APPLICATION

PROJECT TEAM:

Document Set ID: 3481897
Version: 1, Version Date: 24/04/2025

THIS DRAWING HAS BEEN PREPARED BY & IS THE PROPERTY OF URBAN SPACE DESIGNERS - LICENCED BUILDING DESIGNERS AND MAY ONLY BE USED FOR THE PURPOSE FOR WHICH IT WAS COMMISSIONED.

copyright

PROJECT TITLE : - PROPOSED RENOVATION & IMPROVEMENT OF EXISTING RETAIL STORE
AT 1/30 DERWENT PARK, DERWENT PARK ROAD, HOBART. TAS-7009

GLENORCHY CITY COUNCIL
PLANNING SERVICES
APPLICATION No PLN-24-120
DATE RECEIVED 24 April 2025

Date : 21-05-2024

Client:

Mr. LOVLEEN GUPTA

KLM FOODS PTY LTD

Site Address:

30-DERWENT PARK,
DERWENT PARK ROAD,
HOBART.

GENERAL NOTES:

CHECK ALL DIMENSIONS AND MEASUREMENTS ON SITE PRIOR TO FABRICATION AND OR CONSTRUCTION. DIMENSIONS ARE IN MILLIMETERS "FRAME TO FRAME" AND DO NOT ALLOW FOR INTERIOR LININGS.

DO NOT SCALE DRAWINGS. IF IN DOUBT ASK.

ALL WORK IN ACCORDANCE WITH THE BUILDING CODE OF AUSTRALIA (BCA) AS AMENDED, RELEVANT AUSTRALIAN STANDARDS (AS) CODES AND GOOD BUILDING PRACTICES. DRAWINGS TO BE READ IN CONJUNCTION WITH SPECIFICATIONS AND SCHEDULES.

ISSUE	DESCRIPTION	DATE
R1	AREA MATRIX AND NOTES ADVISED BY TASWATER ADDED	22-04-2025

File Number:
KLM/HCC/ARCH/21/05/2024

Title:
LAYOUT PLAN
KITCHEN

Sheet Original:
A - 3

Scale:
1:50

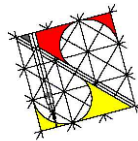

urban space designers
Building Design And Drafting

TASMANIA . VICTORIA

HEMANT KHANNA
0402438170
hemant_khanna@yahoo.com
info@urbanspacedesigners.com.au

Drawn By:
G K

Drawing Number:

BA-03

WALLS

1. Polyvinyl Sheeting with Welded Seams walls in Food Preparation Areas. (3.2.2)
2. Stainless steel wall finish with welded joints for high impact and excess heating areas. (3.2.2)
3. Intersection of Floor with Wall to be as per coving requirements and details.
4. Solid Preformed coving fillet to be used to support the sheeting where it turns up to form a cove. (3.1.5)

FLOORING

1. Non Absorbent easy to clean Floor. (3.1.1)
2. Polyvinyl Sheeting with Welded Seams. (3.1.3)
3. Intersection of Floor with Wall to be as per coving requirements and details.
4. Solid Preformed coving fillet to be used to support the sheeting where it turns up to form a cove. (3.1.5)

CEILING

1. Non Perforated free of open joints, cracks, crevices in food prep areas. (3.2.6)
2. Preformed ceiling Panels for all Areas. (3.2.7)
3. Intersection of Wall with Ceiling to be tightly jointed, sealed and dustproof.
4. Service Pipes, conduits, electrical wiring to be concealed in walls, floor, plinths or ceiling. (3.2.9)

STORAGE FACILITY

In accordance with Tas H102 P11

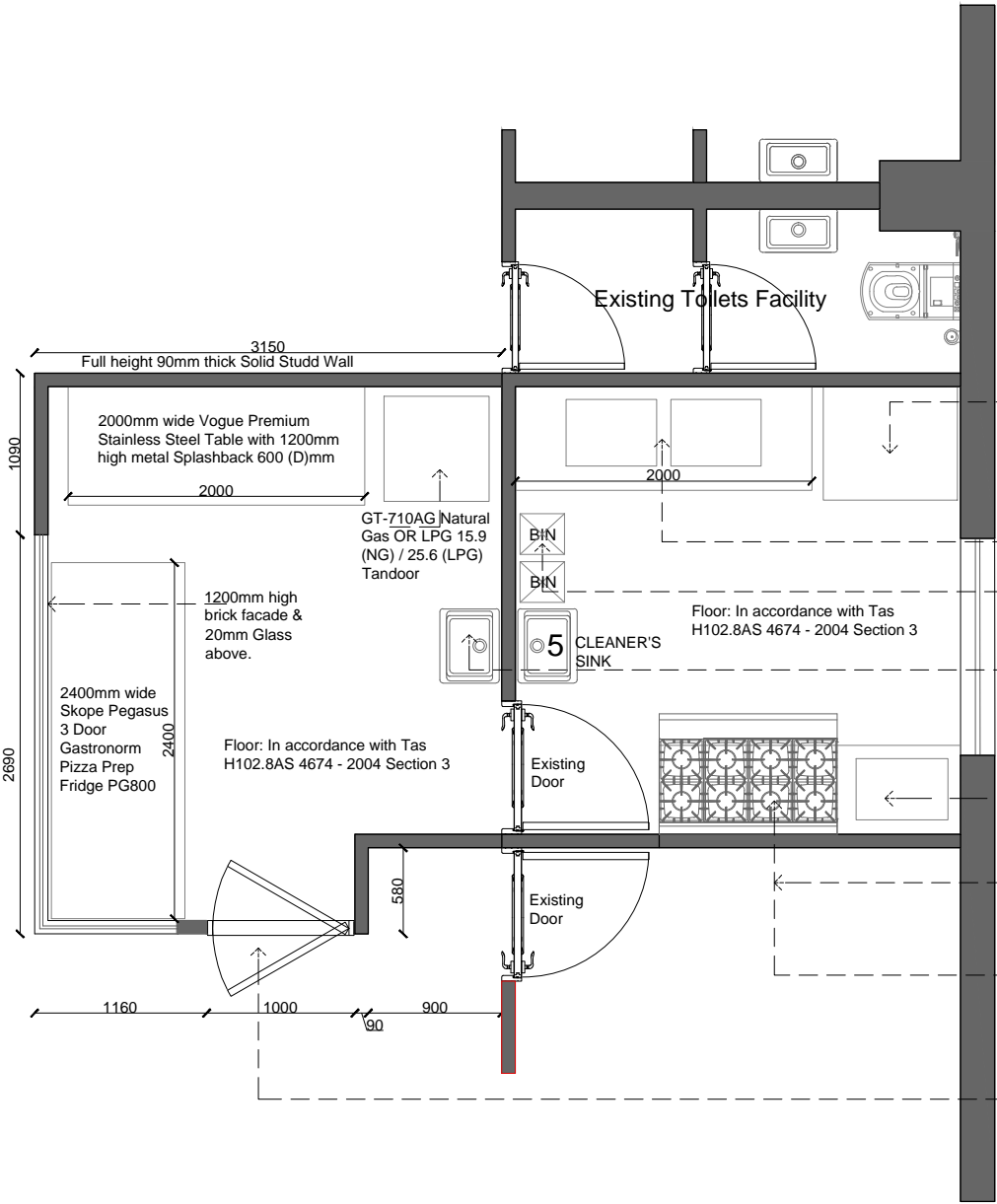

Washtech by Moffat High Efficiency Passthrough ware washer with heat condenser AL&C

Sink for Dish Washing
In accordance with Tas H102.11
Vogue Dishwasher Inlet Table with
2000 mm wide double bowl Sink
90mm outlet 2000 x 700 x 960

GARBAGE AND RECYCLE BINS PROVIDED
In accordance with Tas H102 P4

FIXTURES FITTINGS & EQUIPMENTS
In accordance with Tas H102.10
AS 4674 - 2004 Section 4.4
HAND WASHING FACILITY

Roband Double Pan Fryer 2 x 8Ltr F28

Blue Seal by Moffat 8 Burner Gas
Cooktop Hob G518D LS

EXHAUST (Refer Proposed Mechanical
Ventilation drawing)
Design to be in accordance with AS/NZS
1668.1 and AS 1668.2

PROPOSED SELF CLOSING DOOR
In Accordance with Tas H102.2

1. Double bowl Stainless Steel sink for equipment washing
2. Single Bowl Stainless Steel sink for food preparation
3. Both the sinks to be supplied with —
 - hot and cold water; and
 - an integral drainer on at least one side.
4. Stainless steel sink installed adjacent to the wall, to be fitted with an integral flashing at a height of 150 mm along with the 300mm high ceramic tiles above the flashing.

1. Floor below garbage and Recycle bins to be paved with impervious material. (2.4.2)
2. Garbage Bins to be Constructed of impervious material like metal or plastic. (2.4.4)
3. To have tight fitting lids. (2.4.4)
4. Containers for clean, dry, recyclable materials to be of reinforced polythene material. (2.4.5)

1. Accessible and no further than 5m of Food Handling Area. (4.4.1)
2. Unobstructed location of basin. (4.4.1)
3. Fixed to wall at bench height. (4.4.1)
4. Hot and Cold Water from a Single Outlet with temperature controlled by a thermostatic mixing valve. (4.4.2)
5. Single use Paper or cloth towel dispenser and soap dispenser to be fixed at site. Fixed to wall at bench height. (4.4.3)
6. Basin with minimum 250mm distance between the Spout and the bottom of the Basin.

LAYOUT PLAN
KITCHEN

NOTE: -

- 1) The information contained in this document is copyright and may not be used or reproduced for any other project or purpose. Verify all dimensions and levels on site and report any discrepancies to URBAN SPACE DESIGNERS for direction prior to the commencement of work. Drawings to be read in conjunction with all other contract documents. Use figured dimensions only. Do not scale from drawings. URBAN SPACE DESIGNERS cannot guarantee the accuracy of content and format for copies of drawings issued electronically. If in doubt ask. The completion of the issued details checked and authorized section below is confirmation of the status of the drawing. The drawing shall not be used for the construction unless endorsed "for construction" and authorized for issue.
- 2) Read these drawings in conjunctions with drawings prepared by Urban space designers. Refer any discrepancies with the designer before proceeding with any building works.

DEVELOPMENT APPLICATION

PROJECT TEAM:

Document Set ID: 3481897
Version: 1, Date: 19/04/2025
THIS DRAWING HAS BEEN PREPARED BY & IS THE PROPERTY OF URBAN SPACE DESIGNERS - LICENCED BUILDING DESIGNERS AND MAY ONLY BE USED FOR THE PURPOSE FOR WHICH IT WAS COMMISSIONED.

copyright