

## DEVELOPMENT APPLICATION

<b>APPLICATION NUMBER:</b>	PLN-25-175
<b>PROPOSED DEVELOPMENT:</b>	Change of use to General Retail and Hire
<b>LOCATION:</b>	24C Wyndham Road Claremont
<b>APPLICANT:</b>	Drip Den
<b>ADVERTISING START DATE:</b>	19/08/2025
<b>ADVERTISING EXPIRY DATE:</b>	02/09/2025

Plans and documentation are available for inspection at Council's Offices, located at 374 Main Road, Glenorchy between 8.30 am and 5.00 pm, Monday to Friday (excluding public holidays) and the plans are available on Glenorchy City Council's website ([www.gcc.tas.gov.au](http://www.gcc.tas.gov.au)) until **02/09/25**.

During this time, any person may make representations relating to the applications by letter addressed to the Chief Executive Officer, Glenorchy City Council, PO Box 103, Glenorchy 7010 or by email to [gccmail@gcc.tas.gov.au](mailto:gccmail@gcc.tas.gov.au).

Representations must be received by no later than 11.59 pm on **02/09/25**, or for postal and hand delivered representations, by 5.00 pm on **02/09/25**.

Change of use to  
General Retail and Hire

General Information

Project description: 1 STOREY EXISTING BUILDING, RECONSTRUCTION  
Project Address: 24C Wyndham Road, Claremont  
Owner Name: -  
Owner Name: Jing Wang

Index:

A01 - Cover page  
A02 - Proposed shop elevation & signage  
A03 - Existing floor plan  
A04 - Proposed floor plan  
A05 - Existing and proposed site plan

A11 - Proposed shop elevation #1  
A12 - Proposed shop elevation #2

Site Information

Design Wind Speed: N/A  
Wind Classification: N/A  
Soil Classification: N/A  
Climate Zone: 7  
Bushfire attack level (BAL): N/A  
Alpine Area: No  
Corrosion Environment: Moderate  
Other Site hazards: No

Proposed developed area

Total shop floor area: 172m<sup>2</sup>

Revisions

DATE OF ORIGINAL POINT: 06/04/2019

**GLENORCHY CITY COUNCIL  
PLANNING SERVICES**

**APPLICATION No. : PLN-25-275**

**DATE RECEIVED: 12/08/2025**



Proposed shop fit-out at 24C 24C Wyndham Road, Claremont

GENERAL NOTES:  
Contractor shall verify all dimensions and levels on site before commencement of any work.  
Contractor shall notify any discrepancies before commencement of any work.  
Drawings must not be scaled.  
Contractor shall submit samples and shop drawings before commencing work.  
All work shall be carried out in accordance with the Building Code of Australia and all relevant Australian Standards.  
These designs, plans, specifications and the copyright herein are the property of Oramatis Studio and must not be used, reproduced or copied wholly or in part without the written permission of Oramatis Studio.

REV.	DATE	AMENDMENT
--	--	--



PROJECT: 1 STOREY EXISTING BUILDING  
ADDRESS: 24C Wyndham Road, Claremont  
CLIENT: Jing Wang  
DRAWING: Cover page & Site plan

PLOT DATE: 06/04/2019  
REFERENCE: 1926  
DRAWN: C. Lo  
DRAWING NO: 01  
REV. --



**Oramatis Studio**

212 Elizabeth Street, Hobart  
p: (03) 6286 8440  
e: admin@oramatis.com.au  
Acc. No: CC6540

**GLENORCHY CITY COUNCIL  
PLANNING SERVICES**

**APPLICATION No. :** PLN-25-275

**DATE RECEIVED:** 12/08/2025

Change of use to  
General Retail and Hire



**GLENORCHY CITY COUNCIL  
PLANNING SERVICES**

**APPLICATION No. :** PLN-25-275

**DATE RECEIVED:** 12/08/2025

Change of use to  
General Retail and Hire

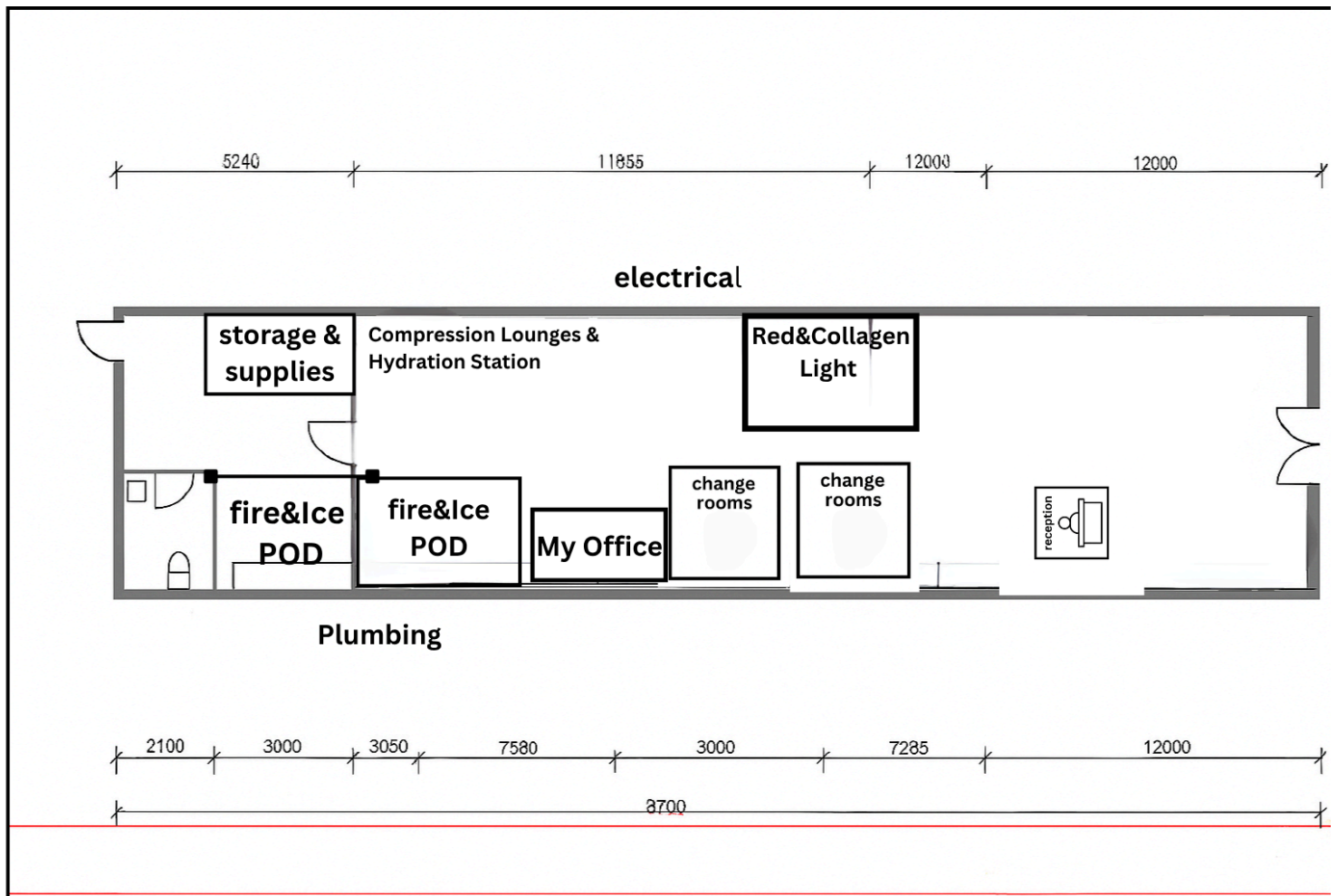

## **Operating Hours**

6.00am to 9.00pm every day